



# SMARTtill<sup>®</sup>

by APG CASH DRAWER

Contact your APG sales representative at (763) 571-5000

## Achieve Simplified Cash Handling

### The SMARTtill<sup>®</sup> Cash Management Solution

The SMARTtill<sup>®</sup> Solution is a new revolution in cash management, enabling retailers to reduce cash losses, reduce the cost of cash handling, and improve in-store productivity. The SMARTtill<sup>®</sup> Solution is an innovative cash management system suitable wherever cash is transacted.

The SMARTtill<sup>®</sup> Intelligent Cash Drawer captures, in real-time, all cash activity at its location and reconciles to sales made. This information is collected without affecting transaction time or interrupting the retail transaction. The SMARTtill<sup>®</sup> Solution can be integrated with your POS hardware/POS application.

The data from the SMARTtill<sup>®</sup> Units can be populated into any suitable database and used to support intelligent cash management to enable real-time cash visibility at the POS. This can be via new or existing back office systems. Examples of the type of information for each SMARTtill<sup>®</sup> Unit, includes; current cash float value; change levels compared to an optimum level; change top up requirements; value of change added; various alerts for cash lifts; cash errors; and discrepancy data by transaction, shift, cashier, time and date.



### Four Key Areas of Impact



#### Operations

- Eradicate manual cash till counts and reduce cash loss investigation time
- Redeploy labor for an improved shopping experience



#### Loss Prevention

- Reduce cash losses by up to 90%
- Full cash transaction audit trail
- Ability to integrate CCTV to pinpoint discrepancies

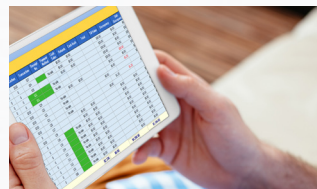

#### Data Analytics

- Security alerts on cash transaction errors, lifts, top ups, and CIT pick ups
- Real time till value at the POS



#### Treasury

- Reduce cash in transit (CIT) fees
- Reinvest your 'dead' cash

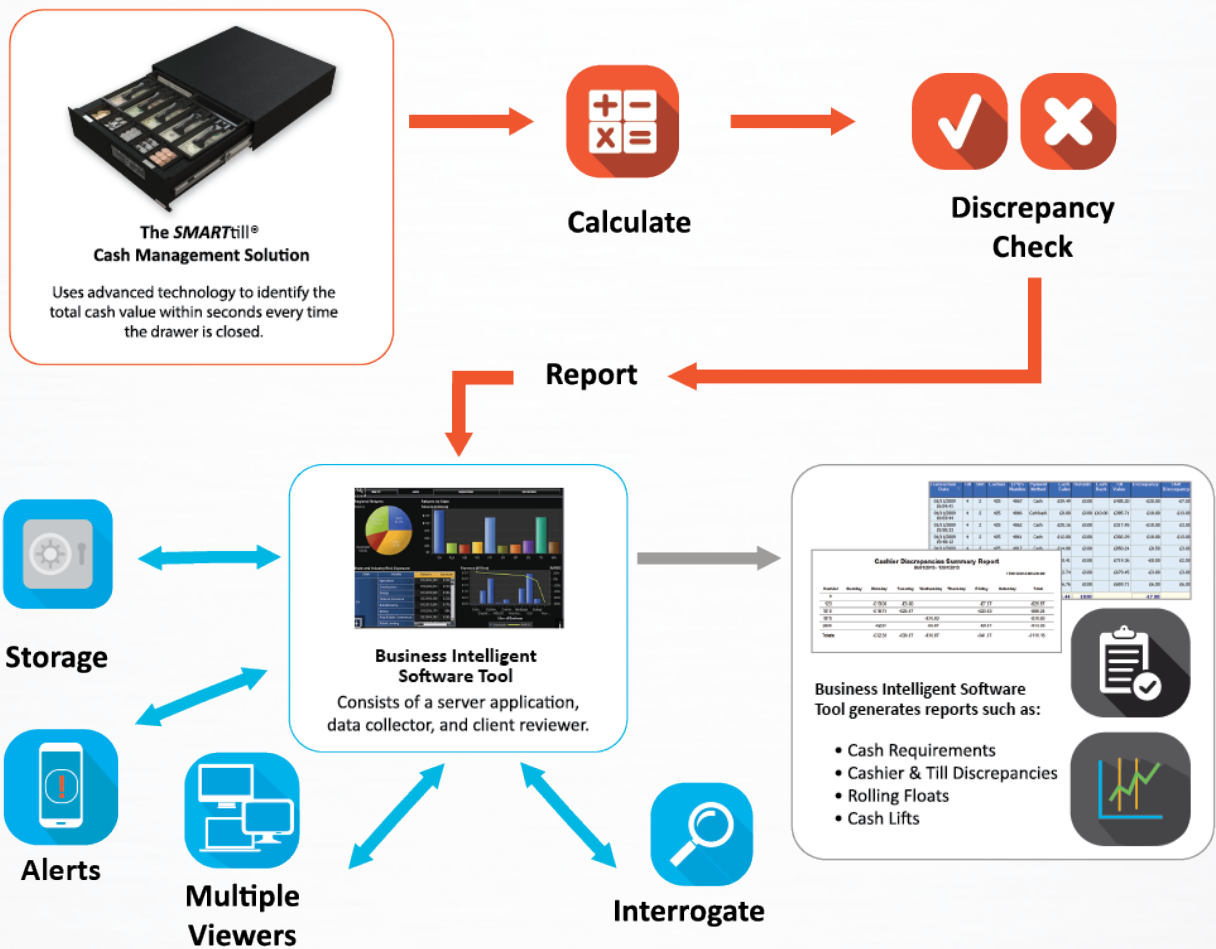

## Intelligent Cash Drawer Features

- |   |  |
|---|--|
| <p><b>Model:</b></p> <ul style="list-style-type: none"> <li>• 50-ST2SLIDE-000</li> </ul> <p><b>Size: (W x D x H)</b></p> <ul style="list-style-type: none"> <li>• (17.36 x 16.61 x 4.72) inches<br/>(441 x 422 x 120) mm</li> </ul> <p><b>Construction/ Color:</b></p> <ul style="list-style-type: none"> <li>• Robust steel construction available in the color Black</li> </ul> <p><b>Life Cycle:</b></p> <ul style="list-style-type: none"> <li>• Tested to a minimum of one million operations</li> </ul> <p><b>Interfaces:</b></p> <ul style="list-style-type: none"> <li>• Standard cash drawer kick out</li> <li>• RS232, USB and TCP/IP Communication ports</li> <li>• Ferrite filtered Ethernet cable should be used when TCP/IP protocol is used</li> </ul> <p><b>POS Software Interfaces:</b></p> <ul style="list-style-type: none"> <li>• Direct command protocol</li> <li>• XML file protocol</li> <li>• Windows JavaPOS and OCX drivers are available when serially configured</li> </ul> | <p><b>Till Aspects:</b></p> <ul style="list-style-type: none"> <li>• 6 weighable compartments with one additional compartment for 'other media'</li> <li>• 5 weighable coin cups</li> <li>• Available in US Dollars</li> <li>• Load bearing sensors beneath each coin and bill compartment</li> <li>• Maximum coin float value: \$163.60</li> <li>• Maximum number of bills in each compartment: 120</li> </ul> <p><b>Mounting:</b></p> <ul style="list-style-type: none"> <li>• Bolt down facility in base</li> </ul> <p><b>Power Requirements:</b></p> <ul style="list-style-type: none"> <li>• 12V - 40V DC at 6 Watts (Dynamic Automatic Voltage)</li> <li>• Optional Power Over Ethernet (class 4 - 48vdc)</li> </ul> |
|---|--|